

SPECIFICATIONS

BIG ROUND FLAT PANEL LIGHT

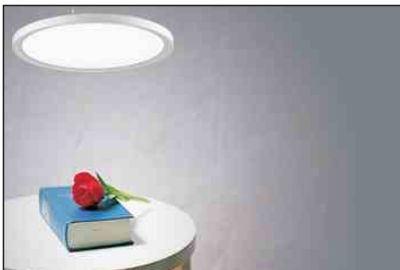

Find additional images and information at
www.billighting.com

Description

- Side lit, even and bright light
- White or bright ring, great appearance;
- Ultra thin, available in limited space in ceiling or wall

Detailed drawing

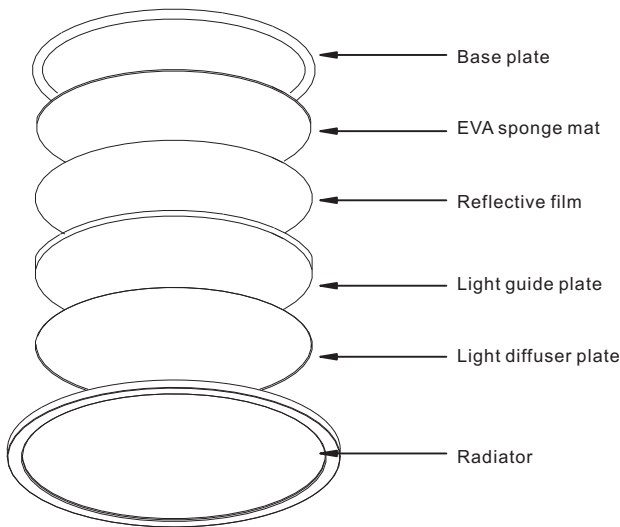

Features

1. Unique structure ensure no light leaking
2. Align with surface, no crack
3. Aluminum alloy, good heat dissipation and no rusting in damp ambience
4. Suspension with strong cables
5. UL, CE, RoHS, FCC certified
6. Die casting aluminum, good heat dissipation and no rusting in damp ambience

Light Distribution Curve

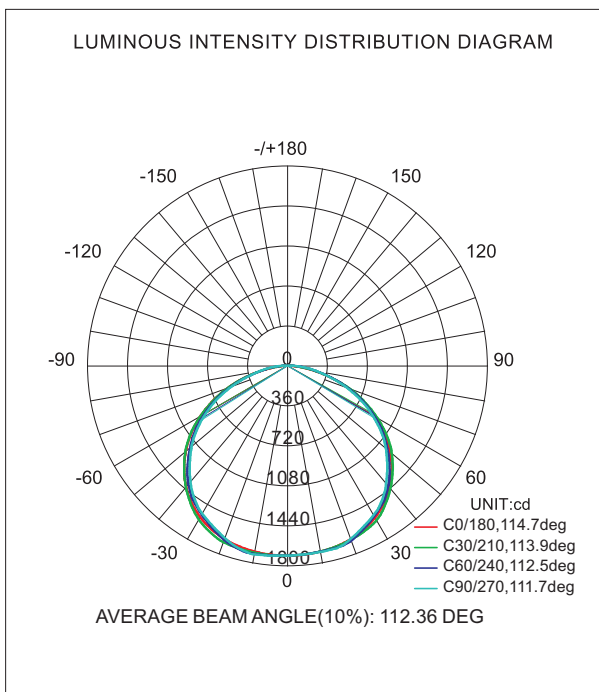

Data sheet

Item	Data
Lumens	80LM/W
Ra	>80
SDCM	<3
PF	>0.9
Starting time	<0.5S
THD	<15%
LED working voltage	32-42V
LED working current	1.4A
Driver efficiency	0.88
Withstand voltage	3750V
IP Grade	IP40
IK Grade	IK06
Fire proof grade	HB

SPECIFICATION

Model Number	Color	CCT	LED Type	Power	Power tolerance	Luminous Flux	Beam Angle
BR-DD800	Cool white	5800-6500	SMD 2835	60W	5%	4968LM	120°
	Pure white	4800-5300	SMD 2835	60W	5%	4738LM	120°
	Nature white	3800-4300	SMD 2835	60W	5%	4738LM	120°
	Warm white	2800-3200	SMD 2835	60W	5%	4596LM	120°

Absolute Maximum Rating

Storage Conditions	0° <TEMP<50°	RH<80%
Working Conditions	0° <TEMP<40°	RH<80%
Frame surface temperature	Tc<60°	
Junction temperature	TJ<70°	

Dimensions (Unit: mm/inch)

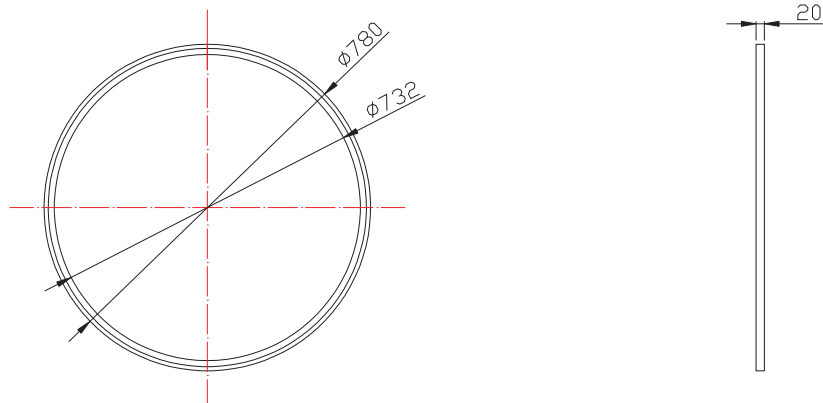

Electrical Connection

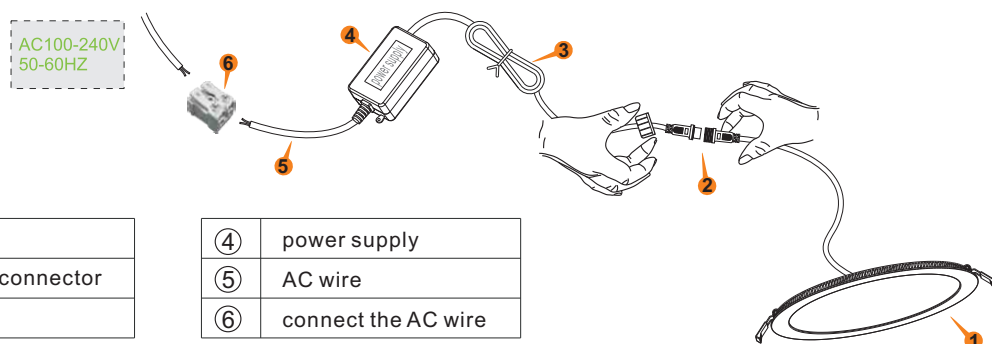

Packing Specification(mm)

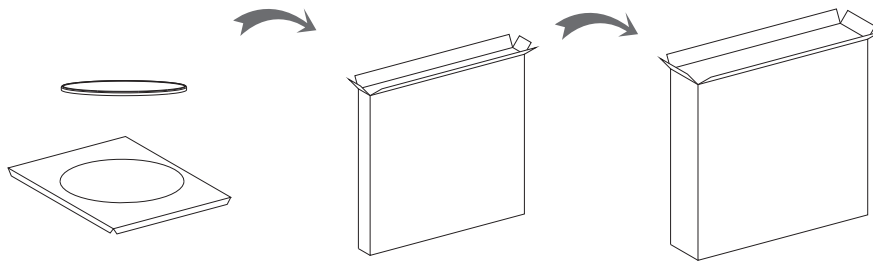

	Size(mm)	N.W/pcs (Kg)	G.W/pcs (Kg)	Q.ty/pcs (pcs)	Carton Q.ty(pcs)	Carton G.W(Kg)
Carton	885x915x50	6.5	7.5	885x915x135	2	15

Installation Instructions

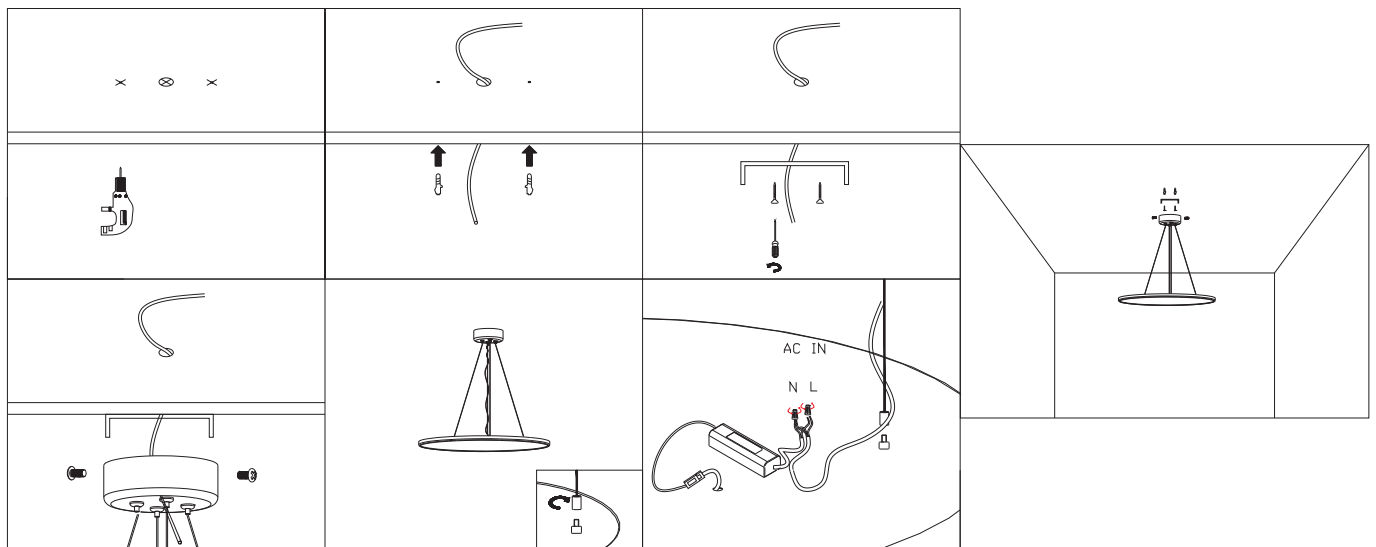

!Notice

- 1.Please read the specification first, to make sure the environment matches the condition in the specification before using.
- 2.Please confirm the applicable power supply before using.
- 3.Make sure the switch of product is off before connect to the power supply to prevent electric shock.
- 4.Operation against rules may damage your property even harm your personal safety.
- 5.Preliminarily estimate required quantity of Round Recessed Flat Panel Light, then according to the power rating of single light to figure out the total power and design power supply plan.
- 6.Dangerous high voltage, Non-professionals are not allowed to maintain the products.
- 7.If the exterior flexible cable or wire is damaged, it must exchange by the supplier, its agent or other similar qualified personnels to avoid dangers.